

ROCKPANEL BOARD $\geq 8\text{mm}$

VENTILATION PROFILE

WINDOWSILL

VENTILATION PROFILE

ROCKPANEL BOARD $\geq 8\text{mm}$

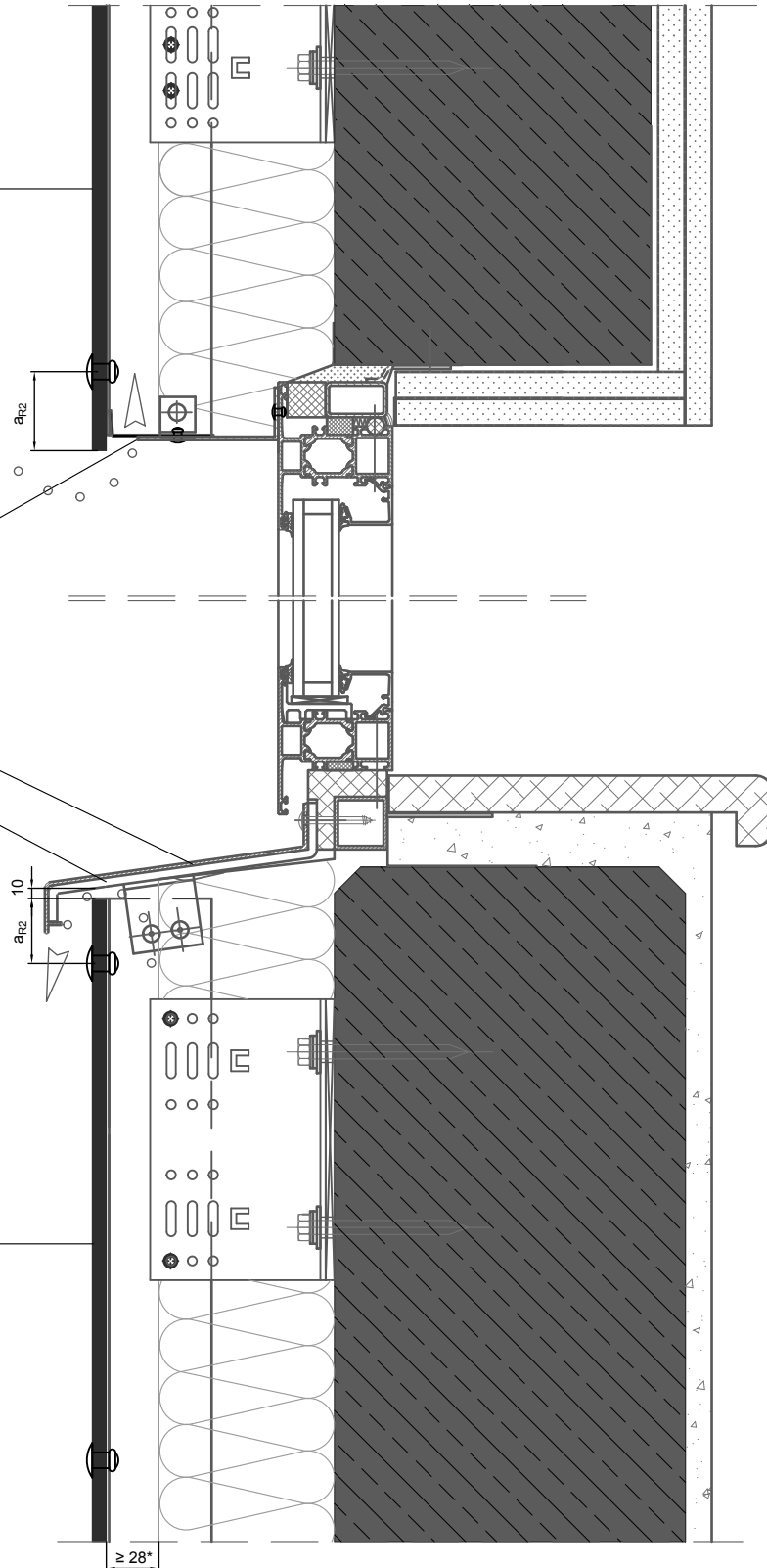

* FOR ALUMINIUM CONSTRUCTIONS IN AN OPEN FACADE
ROCKPANEL GROUP RECOMMENDS A CAVITY DEPTH OF 40 -100mm

**IF A BLACK SHADOW JOINT IS DESIRED, A SHADOW TAPE CAN BE USED.

Detail 2-351

vertical section over window frame with
aluminium substructure with metal reveal

Rockpanel®

a **ROCKWOOL** company